

GE Healthcare

Compact. Smart. Simple.  
It's all within reach.  
Carestation™ 620





# Carestation 620

Introducing a modern design well-suited for today's challenges.

Perioperative care is increasingly complex, but your technology and tools shouldn't be. Designed with versatility in mind, the Carestation 620 is a compact, flexible and easy to use anesthesia system designed to help you deliver reliable anesthesia care to solve today's toughest challenges.

Easy to use and economical to operate, the Carestation 620 is a hybrid of digital technology and classic performance that puts affordable innovation within reach.



The first thing you'll notice about the Carestation 620 is its sleek, modern and compact design made to fit wherever you need it.

**Tactile controls**

**Familiar touchscreen interface**

**Ergonomically friendly**

**Engineered for mobility**

**Durable and stable frame**



# Compact. Smart. Simple.

Classic GE performance and an intuitively familiar user experience.

Clinicians working in today's fast-paced operating rooms require tools that are easy to use. In order to focus more time on the patient, anesthesia technology must balance intuitive user interface design with software intelligence to deliver information that can help enhance patient care. The Carestation 620 combines second-generation digital touchscreen technology with familiar tactile controls that are easy to operate. When seconds count, the seamless and familiar CARESCAPE™-inspired user experience helps you react quickly to changing conditions.

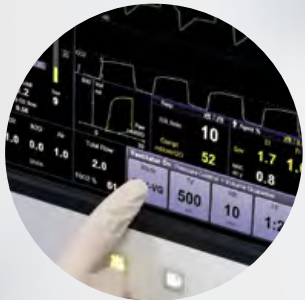

## Familiar touch user interface

The advanced 15-inch touchscreen user interface unites the ventilation and patient monitoring controls for a seamless Carestation experience. The system features a flat menu structure and crisp, high contrast image clarity to make it easy to configure and operate.



## Common touch points

Familiar tactile touches like APL and Bag Vent Switch are designed within reach for an efficient, space optimized clinical workspace that keeps you close to the patient.



## Compact breathing system

The small, compact breathing system features digitally controlled flow valves and fast gas kinetics for rapid wash-in and wash-out to support low flow anesthesia.

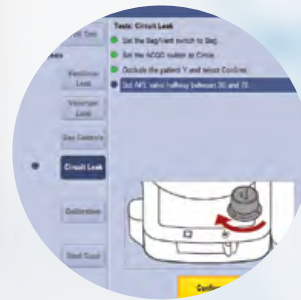

## Fast checkout

The daily checkout process is as simple as it is thorough. Complete the checkout in as fast as three minutes using the clear, step-by-step on-screen guidance.



## Ergonomic controls

Familiar, tactile and easy to use controls are comfortably within reach to help eliminate stretching and awkward positions.



## Intelligent lighting controls

Intelligent lighting highlights active flow controls and visible reinforcement is provided on the ventilation screen to highlight flow status whenever auxiliary ports are in use.



Compact, efficient cockpit-inspired design assures that all essential controls are within reach.



# Reliable.

## Making better possible for over a century.

The Carestation 620's sleek design and simple user interface are just the latest steps in a rich legacy of Carestation systems over the past 100 years. And with 19,000+ hours of reliability and endurance testing, equal to over 450,000 simulated cases, you can trust it to meet the rigorous demands of your OR and beyond.<sup>1</sup> It's all within reach.



500,000+  
Hardware  
component cycles



17,000,000+  
Software actions  
stress test



-60° to +120° C  
Extreme  
temperature  
testing



Rigorous  
interference and  
shock testing



Stability and tip  
testing under  
harsh conditions



Industry-leading  
Lean Six Sigma  
manufacturing



120,000,000+  
Flow sensor tests



1,000,000,000+  
Flow valve cycles



250,000+  
Hardware and  
software reboot  
cycles

15" Touchscreen user interface

Durable materials

Compact Breathing System (CBS-600)

Easy-to-change canister

Three soft-close storage drawers

Small footprint

Carestation 620

Maintenance-free Tec™ 7 vaporizers

Flexible mounting rails

Durable flip shelf



Pendant system option (Carestation 650c)



Wall mount system option (Carestation 650c)



Carestation 650

# Carestation 600 Series

## Carestation 620/650/650c



## **[www.gehealthcare.com](http://www.gehealthcare.com)**

GE Healthcare provides transformational medical technologies and services that are shaping a new age of patient care.

Our broad expertise in medical imaging and information technologies, medical diagnostics, patient monitoring systems, drug discovery, biopharmaceutical manufacturing technologies, performance improvement and performance solutions services help our customers to deliver better care to more people around the world at a lower cost.

In addition, we partner with healthcare leaders, striving to leverage the global policy change necessary to implement a successful shift to sustainable healthcare systems.

## **Imagination at work**